

# SGM-100W

## Monocrystalline Solar Panel (SGM Series)

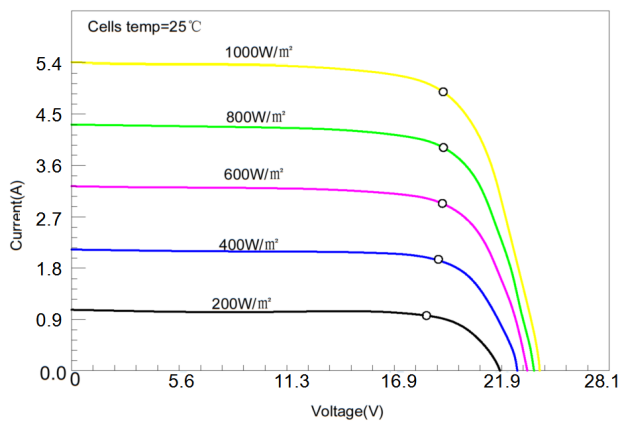

### Module Diagram

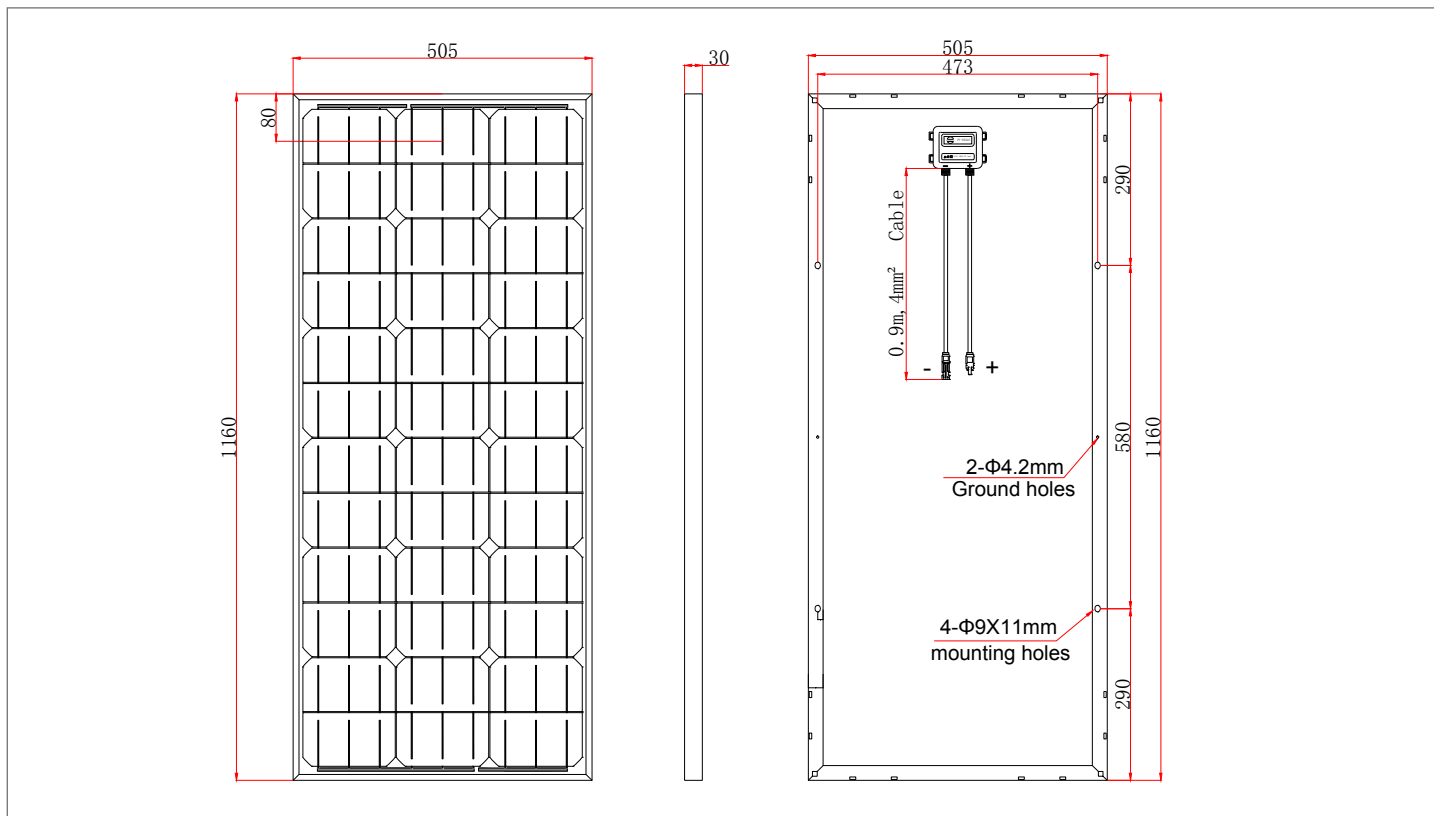

### Electrical Characteristics

Maximum power(Pmax)	100W
Open-circuit voltage(Voc)	23.5
Voltage at Pmax(Vmp)	20.0
Short-circuit current(Isc)	5.30
Current at Pmax(Imp)	5.00
Cells Efficiency(%)	20.40%
The maximum system voltage	1000VDC(IEC)
Power temperature coefficient	-0.43%/°C
Voltage temperature coefficient	-0.34%/°C
Current temperature coefficient	0.05%/°C
Output power tolerance	±3%
Operating Temperature	-40~85°C

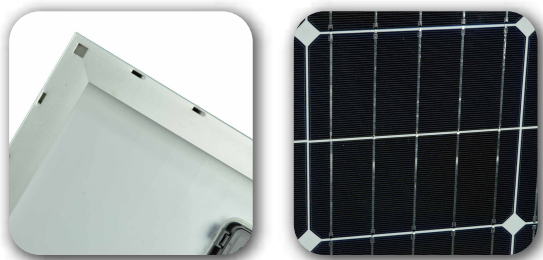

— Product details —

### Specifications

Solar cell brand	A grade solar cells
No.of cells and connections	36(3*12)
Module dimension	505*1160*30mm
Weight	6.46KG
Waterproof junction box	IP65/IP67
Warranty	10 year and service life 25 years